

CHEMICAL PUMP & FILTER
WITH ACID-ALKALI RESISTANCE
EXPERT IN R&D AND MANUFACTURING

Fluorine-lined Magnetic Pump

Model: QBF/QBFZ

Guangdong Qeehua Industry Equipment Co.,Ltd.



Workshop & Warehouse



FLUORINE-LINED MAGNETIC PUMP

USE

Transportation of pesticides, pharmaceuticals, strong acids and bases

Design Features

Simple

QBF removed the back cover, simple structure and long life.

Long Life Friction Material

Silicon carbide friction material, extended service life.



New Material

QBF series uses a lot of new materials

Part Drawing

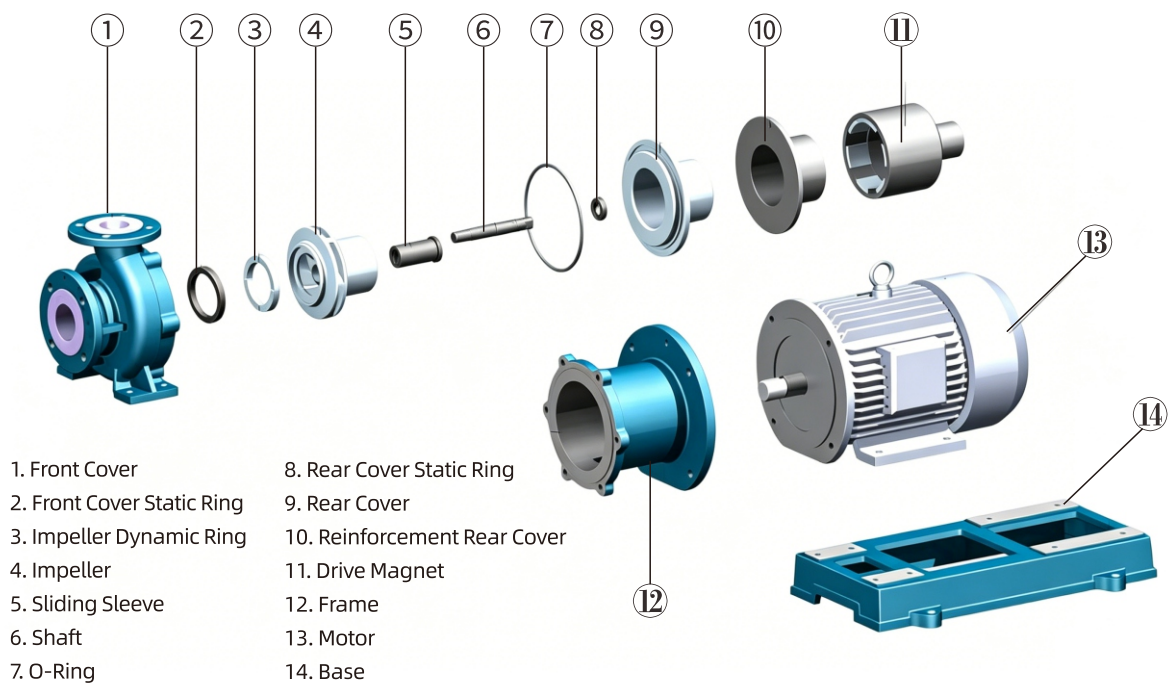

Structure And Materials

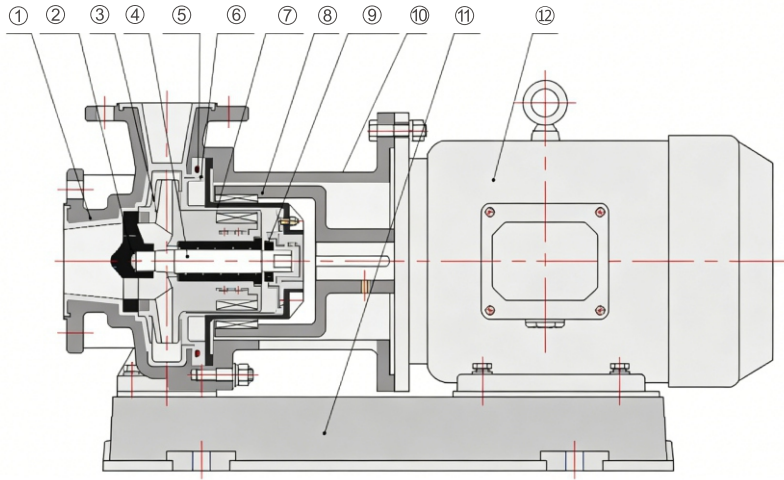

Part name	Material
1. Front Cover	Cast iron(HT200)lined
2. Front Cover Static Ring	SSIC
3. Impeller Assembly	Magnet(NdFeB)lined with F46
4. Shaft	SSIC
5. O-Ring	PTFE
6. Rear Cover	F46
7. Reinforcement Rear Cover	Nylon
8. Drive Magnet	NdFeB
9. Rear Cover Static Ring	SSIC
10. Frame	Cast iron(HT200)
11. Base	Cast iron(HT200)
12. Motor	Cast iron

Model Meaning

QBF40 - 25 - 160 - F - 5 - V38 - A - F - W - A - A - S

① ② ③ ④ ⑤ ⑥ ⑦ ⑧ ⑨ ⑩ ⑪ ⑫ ⑬

① Model No.: QBF

② Inlet Caliber: 25-25mm; 32-32mm; 40-40mm; 50-50mm; 65-65mm; 80-80mm; 100-100mm; 125-125mm; 150-150mm

③ Outlet Diameter: 20-20mm; 25-25mm; 32-32mm; 40-40mm; 50-50mm; 65-65mm; 80-80mm; 100-100mm; 125-125mm

④ Nominal Diameter Of Impeller: 130-130mm; 140-140mm; 160-160mm; 170-170mm; 180-180mm; 200-200mm; 250-250mm; 315-315mm

⑤ Material Of Wet Parts: F-F46; P-PFA

⑥ Frequency: 5-50Hz;6-60Hz

⑦ Voltage: V38-3Ø/380V; V41-3Ø/415V; V44-3Ø/440V; V48-3/480V; V66-3/660V; V32-3Ø/220V; V22-1Ø/220V

⑧ Specific Gravity Of Liquid: A-1.0-1.2;B-1.3;C-1.4;D-1.5;E-1.6;F-1.7;G-1.8; H-1.9; 1-2.0

⑨ Inlet And Outlet Form: F-flange

⑩ Motor Brand: W-WanNan; Q-Other

⑪ Motor Requirements: A-IE3 Normal Motor; B-IE4 Normal Motor; C-IE5 Normal Motor; D-Variable Frequency Motor; E-IE3, BT4 Ex-Proof Motor; F-IE4, BT4 Ex-Proof Motor; G-IE5, BT4 Ex-Proof Motor; H-IE3, CT4 Ex-Proof Motor; I-IE4, CT4 Ex-Proof Motor; J-IE5, CT4 Ex-Proof Motor; K-Permanent magnet variable frequency motor; L-BT4 Ex-Proof Variable frequency Motor; M-CT4 Ex-Proof Variable frequency Motor

⑫ Motor Protection Level: A-IP54;B-IP55;C-IP56; D-IP65

⑬ S-Standard: N-Non-Standard

Performance Data

Model	Rated Flow		Rated Head(m)	Inlet&Outlet (mm)	Reference S.G Range	Power		Weight (kg)
	(L/min)	(m ³ /h)				HP	kW	
QBF25-20-125	33	2	20	25*20	< 1.2	1.5	1.1	35
QBF25-20-160	33	2	32	25*20	< 1.2	1.5	1.1	40
QBF25-20-200	33	2	50	25*20	< 1.2	3	2.2	65
QBF32-20-125	60	4	20	32*20	< 1.2	1.5	1.1	40
QBF32-20-160	60	4	32	32*20	< 1.2	2	1.5	50
QBF32-20-200	60	4	50	32*20	< 1.2	4	3	70
QBF40-25-125	105	6	20	40*25	< 1.2	2	1.5	45
QBF40-25-160	105	6	32	40*25	< 1.2	3	2.2	50
QBF40-25-200	105	6	50	40*25	< 1.2	7.5	5.5	90
QBF40-25-250	105	6	80	40*25	< 1.2	15	11	/
QBF50-32-125	208	13	20	50*32	< 1.2	3	2.2	50
QBF50-32-160	208	13	32	50*32	< 1.2	5.5	4	90
QBF50-32-200	208	13	50	50*32	< 1.2	10	7.5	125
QBF50-32-250	208	13	50	50*32	< 1.2	15	11	/
QBF65-50-125	417	25	20	65*50	< 1.2	5.5	4	90
QBF65-50-160	417	25	32	65*50	< 1.2	7.5	5.5	105
QBF65-40-200	417	25	50	65*40	< 1.2	15	11	160
QBF65-40-250	417	25	80	65*40	< 1.2	25	18.5	230
QBF80-65-125	833	50	20	80*65	< 1.2	7.5	5.5	80
QBF80-65-160	833	50	32	80*65	< 1.2	15	11	135
QBF80-50-200	833	50	50	80*50	< 1.2	25	18.5	190
QBF100-80-125	1667	100	20	100*80	< 1.2	15	11	140
QBF100-80-160	1667	100	32	100*80	< 1.2	25	18.5	195
QBF125-80-160	2667	160	30	125*80	< 1.2	40	30	340
QBF150-125-250	3333	200	20	150*125	< 1.2	30	22-4P	480

Please Understand First

Internal And External Magnetic Steel

Magnetic pump in normal operating conditions, there is no phenomenon of aging demagnetization with the passage of time. But when the pump is overloaded, blocked, slid or operated. When the working temperature is higher than the allowable temperature of magnetic steel, demagnetization will occur. Therefore, the magnetic pump must operate under normal operating conditions.

Strengthening Sleeve

Use high resistivity, high rigidity of non-metallic materials to make strengthening sleeve, effectively avoid magnetic eddy current. The pressure limit of the reinforced sleeve is 2.4 MPA.

Impeller And Mouth Ring

The impeller is molded with fluorine plastic, and the steel insert is wrapped in fluorine plastic to ensure the strength of impeller. The oral ring is generally made of filled polytetrafluoroethylene or silicon carbide material, super wear resistant and corrosion resistant.

Please Understand First

Pump Shell

Made with HT200 lining F46, it can withstand part of the pipe gravity

Base

Adopt HT200 integral casting molding, the upper and lower all adopt the gantry milling machine to flatten, maximize to achieve the level and stability of the pump.

Sliding Bearing

Tetrafluorine filled SIN, SIC, SSIC and other materials, wear-resistant, corrosion resistance.

Please Pay Attention First

1. Ferromagnetic impurity and hard impurity are not allowed in the medium transported by magnetic pump. If there are ferromagnetic particles, magnetic filters are required.
2. The magnetic pump is not allowed to work at a rated flow rate of less than 30%.
3. For liquids with medium density greater than 1400 kg/m, we need to inform our sales department that magnetic couplings need to be redesigned.
4. The suction pressure (inlet pressure) is less than 0.6 MPA and the maximum working pressure is 2.0 MPA.
5. Preventing static electricity destruction: when conveying a liquid with low conductivity, such as ultrapurewater or organic solvent, static electricity will be produced when the pump is running. This will cause discharge and generate electrical sparks, should be taken to elicit electrostatic or other measures.
6. Special medium select special grinding parts, such as hydrofluoric acid, pressureless sintered silicon carbide, nitric acid selected ceramic or silicon carbide.
7. The operating temperature range of fluoroplastic magnetic pump is -20°C - 100°C. When the temperature exceeds 100°C, it is necessary to replace the high-temperature resistant fluorineplastics and the magnetic coupling is redesigned.
8. When the ambient temperature in winter is lower than the solidification temperature of conveying medium, protective measures should be taken.

Special Performance Selection

Optional Name	Description
Electrostatic Conduction Device	Prevention of fire caused by static electricity
Dry Grinding Resistance device	When there is no liquid, make sure it doesn't burn out
Insulation Sleeve	Internal heat preservation of pump to prevent damage to magnetic pump
Motor Protection	Can cut off the power instantly
Special Motor	For special cases
Special Flange	Can make any standard flange

* If you have other requirements, you can contact the sales department

Comprehensive Customer Service

1. Pre-sale services : Assist customer selection
2. After-sales service : Guarantee period of one year, three packets

Easily Damaged Parts

Easily Damaged Parts	Description
Impeller Mouth Ring	24 hours operating conditions, it is recommended to check every 1500 hours. Regular switching machine operating conditions, it is recommended to check once a month. After the long-term shutdown of the operating conditions, it is recommended to check before the boot.
Rotor	
Bearing	
Isolation Sleeve	
Static Ring	
Pump Cover	

FLUORINE SELF-PRIMING MAGNETIC PUMP

USE

Tank absorbent, raw material loading and unloading, suitable for acid and alkali, solvent transportation.

Design Features

Combined with all kinds of advantages, the requirement of no leakage has been achieved.



Part Drawing

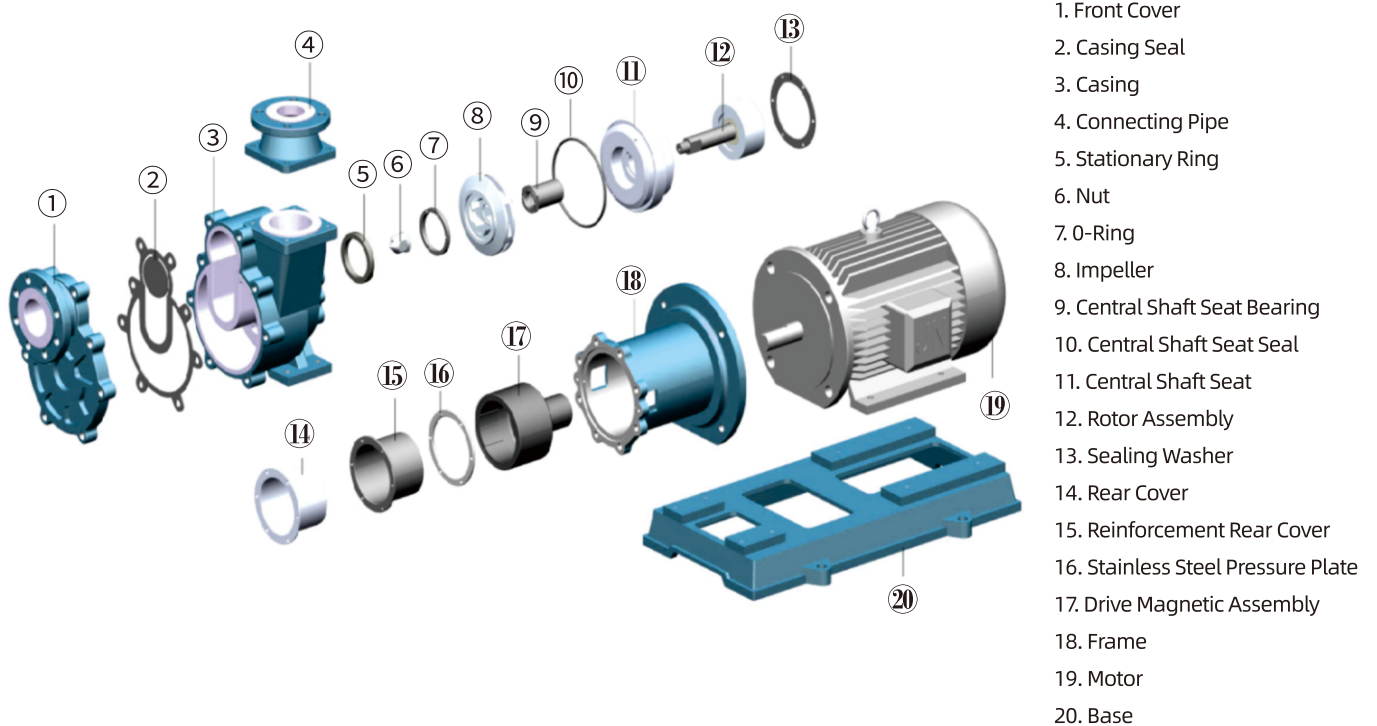

1. Front Cover
2. Casing Seal
3. Casing
4. Connecting Pipe
5. Stationary Ring
6. Nut
7. O-Ring
8. Impeller
9. Central Shaft Seat Bearing
10. Central Shaft Seat Seal
11. Central Shaft Seat
12. Rotor Assembly
13. Sealing Washer
14. Rear Cover
15. Reinforcement Rear Cover
16. Stainless Steel Pressure Plate
17. Drive Magnetic Assembly
18. Frame
19. Motor
20. Base

Structure And Materials

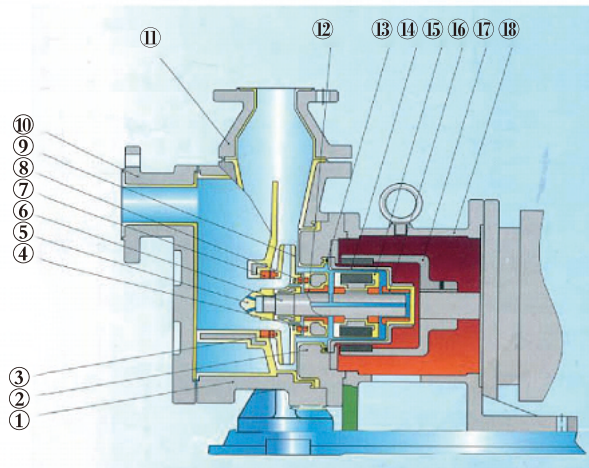

- | | |
|-----------------------|----------------------------|
| 1.Pump Body | 10.Front Cover |
| 2.Pump Cover | 11.Outlet Flange |
| 3.Impeller Front Ring | 12.Front Bearing |
| 4.Thrust Ring | 13.Rear Cover Sealing Ring |
| 5.Impeller Nut | 14.Rear Cover Assembly |
| 6.Spindle | 15.Ratar Assembly |
| 7.Static Ring | 16.Rear Bearing |
| 8.O-Ring | 17.Drive Magnetic |
| 9.Impeller | 18.Frame |

Model Meaning

QBZF40 - 32 -125 - F - 5 - V38 - A - F - W - A - A - S
 ① ② ③ ④ ⑤ ⑥ ⑦ ⑧ ⑨ ⑩ ⑪ ⑫ ⑬

- ① Model No.: QBFZ
- ② Inlet Caliber: 40-40mm; 50-50mm; 65-65mm; 80-80mm
- ③ Outlet Caliber: 32-32mm; 40-40mm; 50-50mm; 65-65mm
- ④ Nominal Diameter Of Impeller:125-125mm; 160-160mm; 200-200mm; 250-250mm
- ⑤ Material Of Wet Parts: F-F46, P-PFA
- ⑥ Frequency: 5-50Hz; 6-60Hz
- ⑦ Voltage: V38-3Ø/380V; V41-3Ø/415V; V44-3Ø/440V; V48-3Ø/480V; V66-3Ø/660V; V32-3/220; V22-1/220V
- ⑧ Specific Gravity Of Liquid: A-1. 0-1.2; B-1.3; C-1.4; D-1.5; E-1.6; F-1.7; G-1.8; H-1.9; 1-2.0
- ⑨ Inlet And Outlet From: F-Flange
- ⑩ Motor Brand: W-WanNan; Q-Other
- ⑪ Motor Requirements: A-IE3 Normal Motor; B-IE4 Normal Motor; C-IE5 Normal Motor; D-Variable Frequency Motor; E-IE3, BT4 Ex-Proof Motor; F-IE4, BT4 Ex-Proof Motor; G-IE5, BT4 Ex-Proof Motor; H-IE3, CT4 Ex-Proof Motor; J-IE5, Ct4 Ex-Proof Motor; K-Permanent magnet variable frequency motor; L-BT4 Ex-Proof Variable Frequency Motor; M-CT4 Ex-Proof Variable Frequency Motor
- ⑫ Motor Protection Level: A-IP54; B-IP55; C-IP56; D-IP65
- ⑬ S-Standard; N-Non-Standard

Performance Data

Model	Rated Flow		Rated Head(m)	Inlet&Outlet (mm)	Referance S.G Range	Power		Weight (kg)
	(L/min)	(m ³ /h)				HP	kW	
QBFZ40-32-125	105	6.3	20	40*32	< 1.2	3	2.2	150
QBFZ40-32-160	105	6.3	32	40*32	< 1.2	5	4	155
QBFZ50-40-125	208.33	12.5	20	50*40	< 1.2	3	2.2	152
QBFZ50-32-160	208.33	12.5	32	50*32	< 1.2	7.5	5.5	158
QBFZ65-50-125	416.67	25	20	65*50	< 1.2	5	4	155
QBFZ65-50-160	416.67	25	32	65*50	< 1.2	10	7.5	165
QBFZ80-65-125	833.33	50	20	80*65	< 1.2	10	7.5	165
QBFZ80-65-160	833.33	50	32	80*65	< 1.2	15	11	190

Please Understand First

Temperature

The normal operating temperature is 95°C, otherwise high temperature material is needed.

Mechanical Seal

Moving ring : Carbon Fibers filled with Tetrafluorine.

Static ring : Using silicon carbide, ceramics, etc.

Please contact us for details.

Impeller Material

The impeller is made of fluorine plastics and steel parts are used internally to ensure the strength.

Pump Cover

The pump case is made of HT200 and F46 and can withstand gravity.

Base

Adopt HT200 integral casting molding, the upper and lower all adopt the gantry milling machine to flatten, maximize to achieve the level and stability of the pump.

Self - Priming

Each self-priming pump is tested and the three-minute self-priming pump does not deliver.

Self - Priming Time

Self-priming time is generally 2 minutes, more than 2 minutes not self- priming, please check the self- priming pump inlet line. When the outlet valve is closed, it will not be able to exhaust and the pump will not be self-priming.

Please Pay Attention First

- 1.Do not contain magnetic impurities and hard objects, otherwise filters are required.
- 2.Can't work at 30% of the flow.
- 3.Transport large density liquid, need to contact us, increase motor power
- 4.The working pressure of the mechanical seal is 1Mpa, the pressure needs to install the high-pressure device, can contact us, make the change.
- 5.Prevent static electricity destruction: when conveying a liquid with low conductivity, such as ultra-pure water or organic solvent, static electricity will occur when the pump. is running. This will cause discharge and generate electrical sparks, should be taken to elicit electrostatic or other measures.
- 6.Special material selection special friction parts.
- 7.The mechanical seal life of QBFZ is 2, 500 hours, which can be shortened by bad environment.
- 8.The self-priming height means the distance from the inlet to the surface of the water.

Special Performance Selection

Optional name	Description
Electric Conduction	Preventing leakage of electricity from disaster
Friction Resistance	To ensure that the magnetic pump doesn't burn out
Motor Protection	Can cut off the power instantly
Non-Standard Motor	For special standards
Non-Standard Flange	Can produce any standard

* If you have any other requirements, please contact us

Comprehensive Customer Service

- 1.Pre-sale services : Help customers choose.
- 2.After-sale service : The warranty is one year.
- 3.Availability of spare parts.

Easily Damaged Parts

Name	Description
Impeller Nozzle Ring	Generally speaking, 1500 hours to check. After a long period of shutdown, turn on the machine for a check
Rotor	
Sliding Bearing	
Isolation Sleeve	
Static Ring	
Pump Cover	

1. High cost performance:

Independent production, stable quality and controllable cost.

2. Excellent product performance:

Corrosion resistance, idling resistance, no leakage, low noise, high efficiency, surface corrosion resistance, durable.

3. Advanced product technology:

Cooperate with colleges and universities to carry out production, learning and research activities, master cutting-edge technology, and constantly make breakthroughs in the direction of low energy consumption and high efficiency. At present, the unique technology includes: 4P motor magnetic pump addresses the problem of rapid temperature rise of liquid medicine, and intelligent monitoring addresses the problem of idling.

4. Continuous upgrading of materials:

Imported CFRETFE material is resistant to strong acid, strong alkali and high temperature.

5. Rich product categories:

It can be upgraded to replace all kinds of old equipment.

6. Three to five year extended warranty:

Make customers free from worry and labor cost.

7. Professional and efficient service:

Before sales, a strong technical team can help customers select models accurately and reduce waste; after sales, tailor training programs for customers to reduce human losses; 4-hour quick response and efficient service!

8. Strong qualification:

Patented technology, CE, SGS quality certification of European Union, government designated supplier

9. Flexible cooperation mode:

Welcome OEM customization and regional agents.

10. Unique family culture:

Stable and happy team, long-term and reliable cooperation.

**Why
choose
Qeehua?**



The enterprise has been engaged in independent research and development since 2012. At present, it has possessed ten utility model patents, one appearance patent and two CE certificates. In addition, it is applying for three utility model patents and two invention patents, and plans to apply for more than 20 kinds of patents.



PART OF OUR SUPPLIERS

Your contribution is indispensable to the high quality products of Qeehua



PART OF OUR CUSTOMERS

Think what the customer thinks, and be grateful to every customer





www.qeehuapump.com



www.qeehua-pump.com

HEAD OFFICE IN SOUTH CHINA:

GUANGDONG QEEHUA INDUSTRY EQUIPMENT CO., LTD.

Address: No.8, East Chenwu Road, Houjie Town, Dongguan City, Guangdong Province, China.

SUBSIDIARY CORPORATION:

DONGGUAN EVER POPULAR IMPORT AND EXPORT CO., LTD.

No. 1301&1302, Tianan Cyber Park, No.1 Huangjin Road, Nancheng District,
Dongguan City, Guangdong Province, China.

SUBSIDIARY CORPORATION:

JIANGXI QEEHUA FLOW TECHNOLOGY CO., LTD.

Address: Room 110, Building 3, Hengke Industrial Park phase 1,
Economic and Technological Development Zone, Ganzhou City, Jiangxi Province, China.

SUBSIDIARY CORPORATION:

SUZHOU QEEHUA PUMP INDUSTRY CO., LTD.

Address: Room 221, Kezheng Building, No. 16, Nantiancheng Road, High - speed Railway New Town,
Xiangcheng District, Suzhou City.

SUBSIDIARY CORPORATION:

CHENGDU QEEHUA FLUID TECHNOLOGY CO., LTD.

No. 08, 3rd Floor, Building 3, No. 1108 Shengbang Street, High tech Zone, Chengdu City, Sichuan Province, China.



Copyright belongs to our company
Product specifications and technical indicators are subject to change without prior notice.

2026.06.02